



MAEER PUNE's

MAHARASHTRA INSTITUTE OF DENTAL SCIENCES & RESEARCH (DENTAL COLLEGE)



Address : Vishwanathpuram Ambajogai Road,
Latur. 413531 (Maharashtra)

Tel : (02382) 227703, 227424
Fax : (02382) 228063

Email : principal@mitmidr.edu.in
midr.latur@gmail.com

Website : www.mitmidr.edu.in



**DEPARTMENT OF ORTHODONTICS AND
DENTOFACIAL ORTHOPAEDICS**



MAEER PUNE'S

MAHARASHTRA INSTITUTE OF DENTAL SCIENCES & RESEARCH (DENTAL COLLEGE)



Address : Vishwanathpuram Ambajogai Road,
Latur. 413531 (Maharashtra)

Tel : (02382) 227703, 227424
Fax : (02382) 228063

Email : principal@mitmidr.edu.in
midr.latur@gmail.com
Website : www.mitmidr.edu.in

DEPARTMENT INFRASTRUCTURE

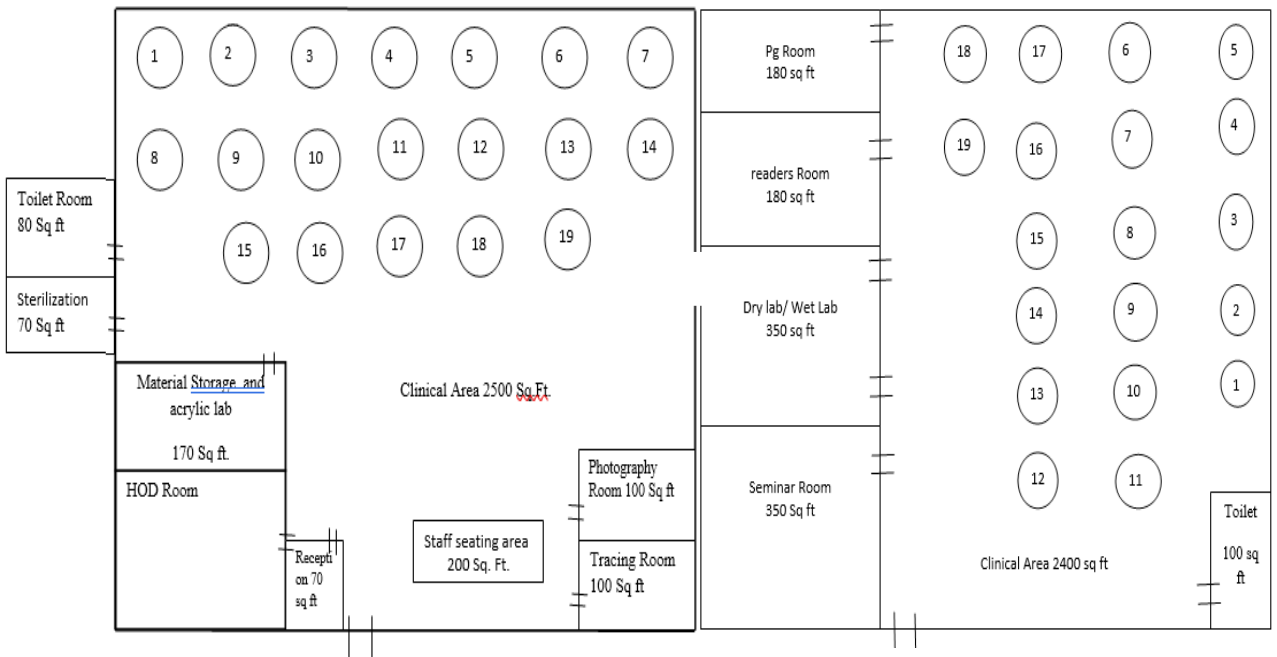

Patient Waiting and corridor

500 Sq Ft.

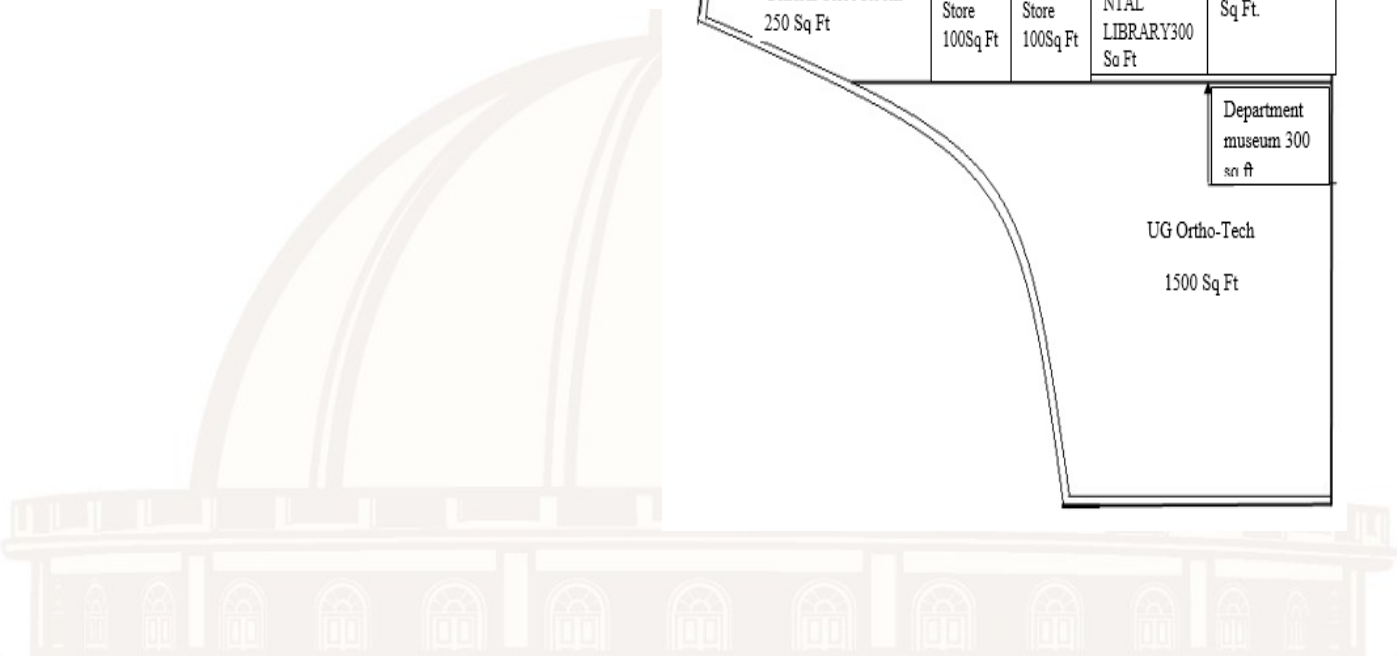
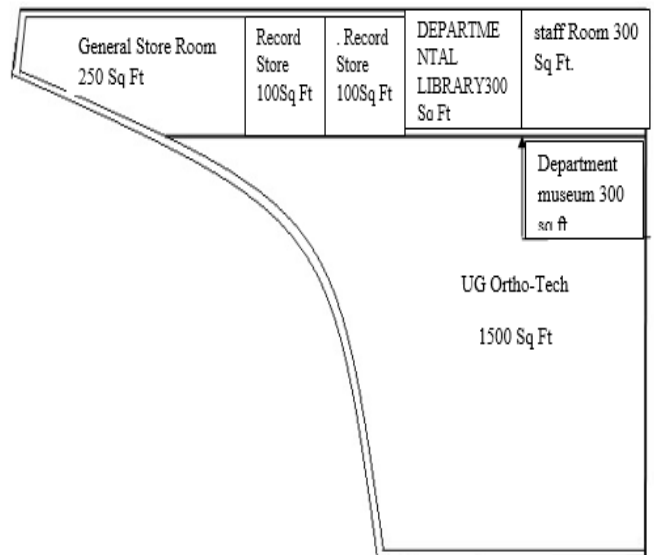



MAEER PUNE's

MAHARASHTRA INSTITUTE OF DENTAL SCIENCES & RESEARCH (DENTAL COLLEGE)



Address : Vishwanathpuram Ambajogai Road,
Latur. 413531 (Maharashtra)

Tel : (02382) 227703, 227424
Fax : (02382) 228063

Email : principal@mitmidsr.edu.in
midsr.latur@gmail.com
Website : www.mitmidsr.edu.in



GPS Map Camera

Latur, MH, India

Vishwanathpuram, Latur, 413531, MH, India

Lat 18.429242, Long 76.578177

03/15/2023 11:33 AM GMT+05:30

Note : Captured by GPS Map Camera

DEPARTMENT OF ORTHODONTICS



GPS Map Camera

Latur, MH, India

Vishwanathpuram, Latur, 413531, MH, India

Lat 18.429573, Long 76.578155

03/15/2023 11:02 AM GMT+05:30

Note : Captured by GPS Map Camera

DEPARTMENT OF ORTHODONTICS
PATIENT WAITING AREA



MAEER PUNE's

MAHARASHTRA INSTITUTE OF DENTAL SCIENCES & RESEARCH (DENTAL COLLEGE)



Address : Vishwanathpuram Ambajogai Road,
Latur. 413531 (Maharashtra)

Tel : (02382) 227703, 227424
Fax : (02382) 228063

Email : principal@mitmidsr.edu.in
midsr.latur@gmail.com
Website : www.mitmidsr.edu.in



**DEPARTMENT OF
ORTHODONTICS
POST GRADUATE SECTION**



MAEER PUNE's

MAHARASHTRA INSTITUTE OF DENTAL SCIENCES & RESEARCH (DENTAL COLLEGE)



Address : Vishwanathpuram Ambajogai Road,
Latur. 413531 (Maharashtra)

Tel : (02382) 227703, 227424
Fax : (02382) 228063

Email : principal@mitmidsr.edu.in
midsr.latur@gmail.com
Website : www.mitmidsr.edu.in



GPS Map Camera

Latur, MH, India

Vishwanathpuram, Latur, 413531, MH, India
Lat 18.428896, Long 76.577437
03/15/2023 10:59 AM GMT+05:30
Note : Captured by GPS Map Camera

**DEPARTMENT OF ORTHODONTICS
UNDER GRADUATE SECTION**



GPS Map Camera

Latur, MH, India

Vishwanathpuram, Latur, 413531, MH, India
Lat 18.428779, Long 76.577347
03/15/2023 11:01 AM GMT+05:30
Note : Captured by GPS Map Camera



MAEER PUNE's

MAHARASHTRA INSTITUTE OF DENTAL SCIENCES & RESEARCH (DENTAL COLLEGE)



Address : Vishwanathpuram Ambajogai Road,
Latur. 413531 (Maharashtra)

Tel : (02382) 227703, 227424
Fax : (02382) 228063

Email : principal@mitmidr.edu.in
midr.latur@gmail.com
Website : www.mitmidr.edu.in



RECEPTION - DEPARTMENT OF ORTHODONTICS



MAEER PUNE'S

MAHARASHTRA INSTITUTE OF DENTAL SCIENCES & RESEARCH (DENTAL COLLEGE)



Address : Vishwanathpuram Ambajogai Road,
Latur. 413531 (Maharashtra)

Tel : (02382) 227703, 227424
Fax : (02382) 228063

Email : principal@mitmidsr.edu.in
midsr.latur@gmail.com

Website : www.mitmidsr.edu.in



HOD ROOM - DEPARTMENT OF ORTHODONTICS



MAEER PUNE's

MAHARASHTRA INSTITUTE OF DENTAL SCIENCES & RESEARCH (DENTAL COLLEGE)



Address : Vishwanathpuram Ambajogai Road,
Latur. 413531 (Maharashtra)

Tel : (02382) 227703, 227424
Fax : (02382) 228063

Email : principal@mitmidsr.edu.in
midsr.latur@gmail.com
Website : www.mitmidsr.edu.in



**PG PRECLINICAL LABORATORY DEPARTMENT OF
ORTHODONTICS**

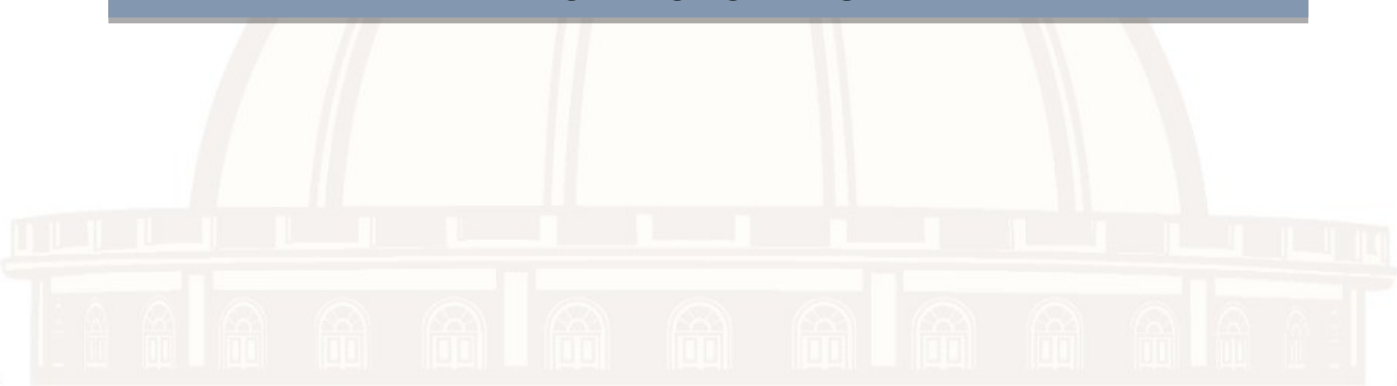



MAEER PUNE's

MAHARASHTRA INSTITUTE OF DENTAL SCIENCES & RESEARCH (DENTAL COLLEGE)



Address : Vishwanathpuram Ambajogai Road,
Latur. 413531 (Maharashtra)

Tel : (02382) 227703, 227424
Fax : (02382) 228063

Email : principal@mitmidr.edu.in
midr.latur@gmail.com
Website : www.mitmidr.edu.in



STERILIZATION ROOM - DEPARTMENT OF ORTHODONTICS



MAEER PUNE's

MAHARASHTRA INSTITUTE OF DENTAL SCIENCES & RESEARCH (DENTAL COLLEGE)



Address : Vishwanathpuram Ambajogai Road,
Latur. 413531 (Maharashtra)

Tel : (02382) 227703, 227424
Fax : (02382) 228063

Email : principal@mitmidsr.edu.in
midsr.latur@gmail.com
Website : www.mitmidsr.edu.in



PHOTOGRAPY SECTION - DEPARTMENT OF ORTHODONTICS



MAEER PUNE's

MAHARASHTRA INSTITUTE OF DENTAL SCIENCES & RESEARCH (DENTAL COLLEGE)



Address : Vishwanathpuram Ambajogai Road,
Latur. 413531 (Maharashtra)

Tel : (02382) 227703, 227424
Fax : (02382) 228063

Email : principal@mitmidsr.edu.in
midsr.latur@gmail.com
Website : www.mitmidsr.edu.in



CEPH TRACING ROOM - DEPARTMENT OF ORTHODONTICS



MAEER PUNE's

MAHARASHTRA INSTITUTE OF DENTAL SCIENCES & RESEARCH (DENTAL COLLEGE)



Address : Vishwanathpuram Ambajogai Road,
Latur. 413531 (Maharashtra)

Tel : (02382) 227703, 227424
Fax : (02382) 228063

Email : principal@mitmidsr.edu.in
midsr.latur@gmail.com

Website : www.mitmidsr.edu.in



**PATIENT RECORD MAINTENANCE SECTION DEPARTMENT OF
ORTHODONTICS**



MAEER PUNE's

MAHARASHTRA INSTITUTE OF DENTAL SCIENCES & RESEARCH (DENTAL COLLEGE)

ESTD 2006



Address : Vishwanathpuram Ambajogai Road,
Latur. 413531 (Maharashtra)

Tel : (02382) 227703, 227424
Fax : (02382) 228063

Email : principal@mitmidsr.edu.in
midsr.latur@gmail.com
Website : www.mitmidsr.edu.in



DEPARTMENTAL LIBRARY



MAEER PUNE's

MAHARASHTRA INSTITUTE OF DENTAL SCIENCES & RESEARCH (DENTAL COLLEGE)

ESTD 2006



Address : Vishwanathpuram Ambajogai Road,
Latur. 413531 (Maharashtra)

Tel : (02382) 227703, 227424
Fax : (02382) 228063

Email : principal@mitmidsr.edu.in
midsr.latur@gmail.com
Website : www.mitmidsr.edu.in



SEMINAR ROOM - DEPARTMENT OF ORTHODONTICS



GPS Map Camera

Latur, Maharashtra, India
CHJH+36W, Vishwanathpuram, Latur,
Maharashtra 413512, India
Lat 18.429896°
Long 76.577904°
07/03/23 11:45 AM GMT +05:30



Google



MAEER PUNE's

MAHARASHTRA INSTITUTE OF DENTAL SCIENCES & RESEARCH (DENTAL COLLEGE)



Address : Vishwanathpuram Ambajogai Road,
Latur. 413531 (Maharashtra)

Tel : (02382) 227703, 227424
Fax : (02382) 228063

Email : principal@mitmidsr.edu.in
midsr.latur@gmail.com
Website : www.mitmidsr.edu.in



WET LABORATORY



DRY LABORATORY



MAEER PUNE's

MAHARASHTRA INSTITUTE OF DENTAL SCIENCES & RESEARCH (DENTAL COLLEGE)



Address : Vishwanathpuram Ambajogai Road,
Latur. 413531 (Maharashtra)

Tel : (02382) 227703, 227424
Fax : (02382) 228063

Email : principal@mitmidsr.edu.in
midsr.latur@gmail.com

Website : www.mitmidsr.edu.in



READER ROOM - DEPARTMENT OF ORTHODONTICS



MAEER PUNE's

MAHARASHTRA INSTITUTE OF DENTAL SCIENCES & RESEARCH (DENTAL COLLEGE)



Address : Vishwanathpuram Ambajogai Road,
Latur. 413531 (Maharashtra)

Tel : (02382) 227703, 227424
Fax : (02382) 228063

Email : principal@mitmidsr.edu.in
midsr.latur@gmail.com

Website : www.mitmidsr.edu.in



PG STUDENTS ROOM - DEPARTMENT OF ORTHODONTICS



MAEER PUNE's

MAHARASHTRA INSTITUTE OF DENTAL SCIENCES & RESEARCH (DENTAL COLLEGE)



Address : Vishwanathpuram Ambajogai Road,
Latur. 413531 (Maharashtra)

Tel : (02382) 227703, 227424
Fax : (02382) 228063

Email : principal@mitmidsr.edu.in
midsr.latur@gmail.com
Website : www.mitmidsr.edu.in



MUSEUM - DEPARTMENT OF ORTHODONTICS

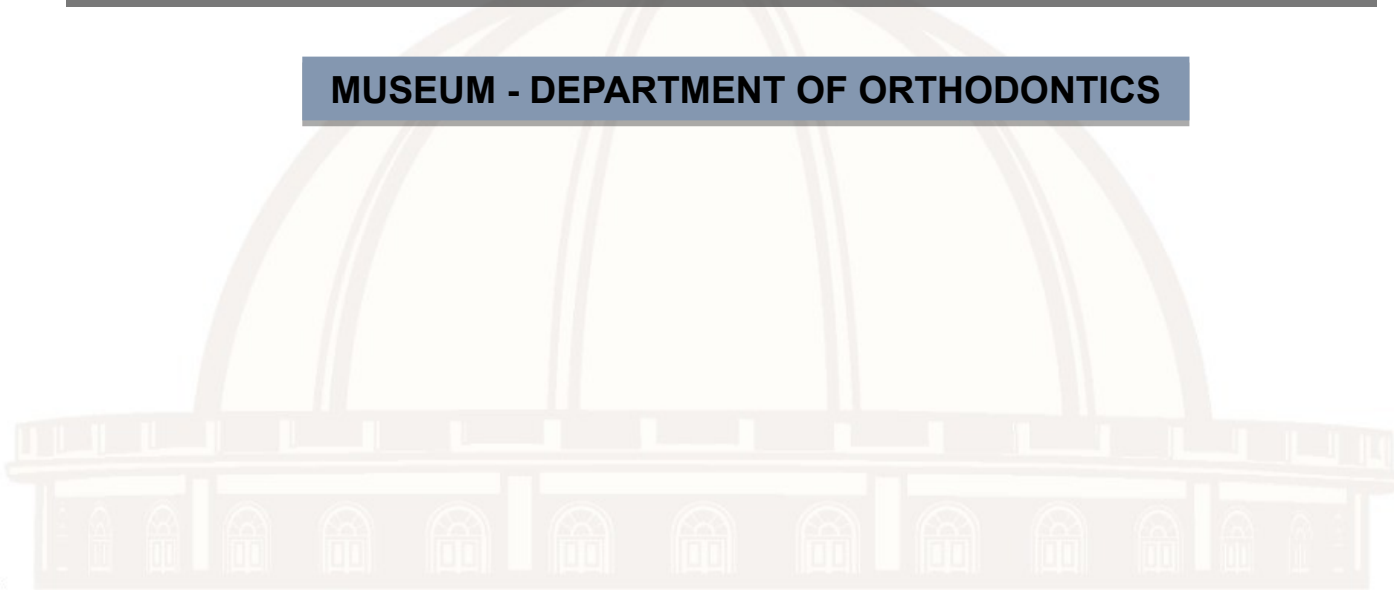



MAEER PUNE's

MAHARASHTRA INSTITUTE OF DENTAL SCIENCES & RESEARCH (DENTAL COLLEGE)



Address : Vishwanathpuram Ambajogai Road,
Latur. 413531 (Maharashtra)

Tel : (02382) 227703, 227424
Fax : (02382) 228063

Email : principal@mitmidrs.edu.in
midrs.latur@gmail.com

Website : www.mitmidrs.edu.in



GPS Map Camera

Latur, Maharashtra, India
CHJG+4XF, Vishwanathpuram, Latur,
Maharashtra 413512, India
Lat 18.429511°
Long 76.578153°
03/03/23 03:15 PM GMT +05:30

Google

**ORTHO – PEDO PRECLINICAL
LABORATORY**



GPS Map Camera

Latur, Maharashtra, India
CHJG+4XF, Vishwanathpuram, Latur,
Maharashtra 413512, India
Lat 18.42951°
Long 76.578152°
03/03/23 03:15 PM GMT +05:30

Google



MAEER PUNE's

MAHARASHTRA INSTITUTE OF DENTAL SCIENCES & RESEARCH (DENTAL COLLEGE)



Address : Vishwanathpuram Ambajogai Road,
Latur. 413531 (Maharashtra)

Tel : (02382) 227703, 227424
Fax : (02382) 228063

Email : principal@mitmidrs.edu.in
midrs.latur@gmail.com
Website : www.mitmidrs.edu.in

LIST OF EQUIPMENTS

1	Dental Chairs and Unit	One chair & unit per PG student and Two chairs with unit for the faculty	Availability
		2 Units	
2	Vacuum /pressure moulding unit	1	1
3	Hydrogen soldering unit	1	1
4	Lab micromotor	5	5
5	Spot welders	5	5
6	Model trimmer (Double disc)	3	3
7	Light curing unit	2	2
8	High intensity light curing unit	2	2
9	Polishing lathes	3	3
10	Tracing tables	5	5
11	SLR digital camera	1	1
12	Scanner with transparency adapter	1	1
13	X-ray viewer	4	4
14	LCD projector	1	1
15	Autoclaves for bulk instrument Sterilization vacuum (Front loading)	1	1
16	Needle destroyer	1	1



MAEER PUNE's

MAHARASHTRA INSTITUTE OF DENTAL SCIENCES & RESEARCH (DENTAL COLLEGE)



Address : Vishwanathpuram Ambajogai Road,
Latur. 413531 (Maharashtra)

Tel : (02382) 227703, 227424
Fax : (02382) 228063

Email : principal@mitmidsr.edu.in
midsr.latur@gmail.com
Website : www.mitmidsr.edu.in

17	Dry heat sterilizer	1	1
18	Ultrasonic scaler	1	1
19	Sets of Orthodontic pliers	3	3
20	Orthodontic impression trays	5	5
21	Ultrasonic cleaner capacity 3.5 lts	1	1
22	Electropolisher	1	1
23	Typodonts with full teeth set	3	3
24	Anatomical articulator with face bow attachments	1	1
25	Free plane articulators	1	1
26	Hinge articulators	4	4
27	Computer software for cephalometrics	1	1
28	Computer with internet connection with attached printer and scanner	1	1
29	Refrigerator	1	1



MAEER PUNE's

MAHARASHTRA INSTITUTE OF DENTAL SCIENCES & RESEARCH (DENTAL COLLEGE)



Address : Vishwanathpuram Ambajogai Road,
Latur. 413531 (Maharashtra)

Tel : (02382) 227703, 227424
Fax : (02382) 228063

Email : principal@mitmidsr.edu.in
midsr.latur@gmail.com
Website : www.mitmidsr.edu.in



GPS Map Camera

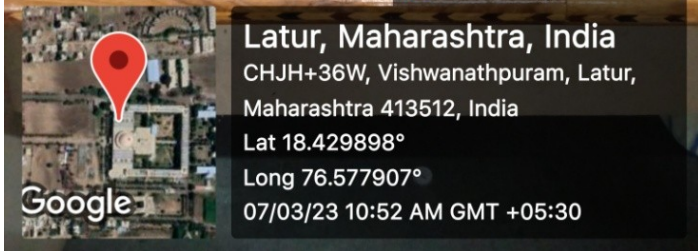

Latur, Maharashtra, India
CHJH+36W, Vishwanathpuram, Latur,
Maharashtra 413512, India
Lat 18.429898°
Long 76.577907°
07/03/23 10:52 AM GMT +05:30

VACUUM /PRESSURE MOULDING UNIT



GPS Map Camera



Latur, Maharashtra, India
CHJH+36W, Vishwanathpuram, Latur,
Maharashtra 413512, India
Lat 18.429897°
Long 76.577906°
07/03/23 10:50 AM GMT +05:30

HYDROGEN SOLDERING UNIT



MAEER PUNE's

MAHARASHTRA INSTITUTE OF DENTAL SCIENCES & RESEARCH (DENTAL COLLEGE)



Address : Vishwanathpuram Ambajogai Road,
Latur. 413531 (Maharashtra)

Tel : (02382) 227703, 227424
Fax : (02382) 228063

Email : principal@mitmidr.edu.in
midr.latur@gmail.com
Website : www.mitmidr.edu.in



LAB MICROMOTOR



SPOT WELDERS



MAEER PUNE's

MAHARASHTRA INSTITUTE OF DENTAL SCIENCES & RESEARCH (DENTAL COLLEGE)



Address : Vishwanathpuram Ambajogai Road,
Latur. 413531 (Maharashtra)

Tel : (02382) 227703, 227424
Fax : (02382) 228063

Email : principal@mitmidsr.edu.in
midsr.latur@gmail.com
Website : www.mitmidsr.edu.in

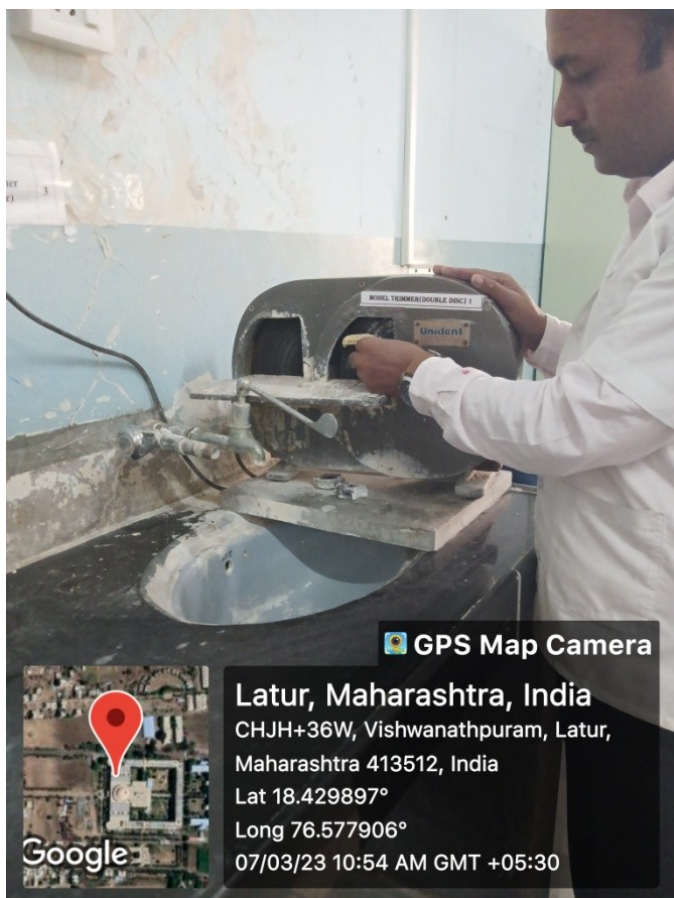

GPS Map Camera



Latur, Maharashtra, India
CHJH+36W, Vishwanathpuram, Latur,
Maharashtra 413512, India
Lat 18.429897°
Long 76.577906°
07/03/23 10:54 AM GMT +05:30

MODEL TRIMMER (DOUBLE DISC)



GPS Map Camera



Latur, Maharashtra, India
CHJH+36W, Vishwanathpuram, Latur,
Maharashtra 413512, India
Lat 18.429897°
Long 76.577906°
07/03/23 10:58 AM GMT +05:30

LIGHT CURING UNIT



MAEER PUNE's

MAHARASHTRA INSTITUTE OF DENTAL SCIENCES & RESEARCH (DENTAL COLLEGE)



Address : Vishwanathpuram Ambajogai Road,
Latur. 413531 (Maharashtra)

Tel : (02382) 227703, 227424
Fax : (02382) 228063

Email : principal@mitmidr.edu.in
midr.latur@gmail.com

Website : www.mitmidr.edu.in



GPS Map Camera

Latur, Maharashtra, India
CHJH+36W, Vishwanathpuram, Latur,
Maharashtra 413512, India
Lat 18.429897°
Long 76.577906°
07/03/23 10:58 AM GMT +05:30

Google

**HIGH INTENSITY LIGHT
CURING UNIT**



GPS Map Camera

Latur, Maharashtra, India
CHJH+36W, Vishwanathpuram, Latur,
Maharashtra 413512, India
Lat 18.429899°
Long 76.577907°
07/03/23 11:04 AM GMT +05:30

Google

POLISHING LATHES



MAEER PUNE's

MAHARASHTRA INSTITUTE OF DENTAL SCIENCES & RESEARCH (DENTAL COLLEGE)



Address : Vishwanathpuram Ambajogai Road,
Latur. 413531 (Maharashtra)

Tel : (02382) 227703, 227424
Fax : (02382) 228063

Email : principal@mitmidsr.edu.in
midsr.latur@gmail.com

Website : www.mitmidsr.edu.in

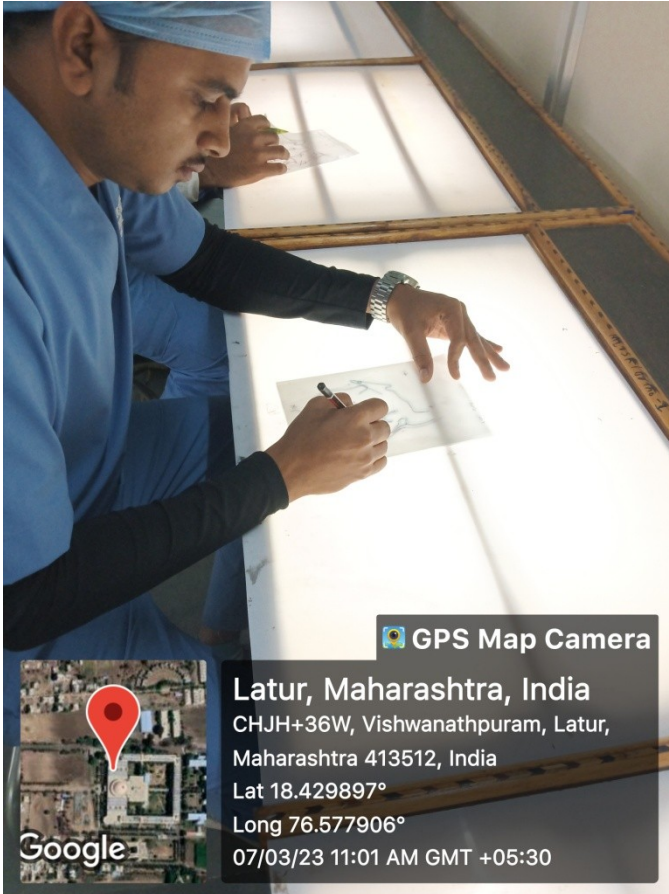

GPS Map Camera

Latur, Maharashtra, India

CHJH+36W, Vishwanathpuram, Latur,
Maharashtra 413512, India

Lat 18.429897°

Long 76.577906°

07/03/23 11:01 AM GMT +05:30

TRACING TABLES



GPS Map Camera

Latur, Maharashtra, India

CHJH+36W, Vishwanathpuram, Latur,
Maharashtra 413512, India

Lat 18.429898°

Long 76.577906°

07/03/23 11:08 AM GMT +05:30

SLR DIGITAL CAMERA



MAEER PUNE's

MAHARASHTRA INSTITUTE OF DENTAL SCIENCES & RESEARCH (DENTAL COLLEGE)



Address : Vishwanathpuram Ambajogai Road,
Latur. 413531 (Maharashtra)

Tel : (02382) 227703, 227424
Fax : (02382) 228063

Email : principal@mitmidsr.edu.in
midsr.latur@gmail.com

Website : www.mitmidsr.edu.in



X-RAY VIEWER

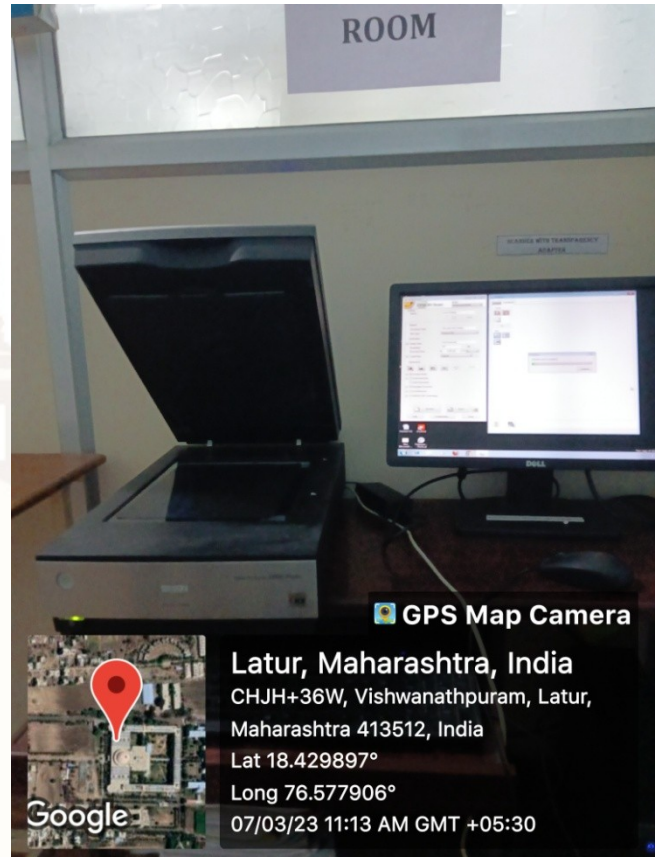

SCANNER WITH TRANSPARENCY ADAPTER



MAEER PUNE'S

MAHARASHTRA INSTITUTE OF DENTAL SCIENCES & RESEARCH (DENTAL COLLEGE)



Address : Vishwanathpuram Ambajogai Road,
Latur. 413531 (Maharashtra)

Tel : (02382) 227703, 227424
Fax : (02382) 228063

Email : principal@mitmidsr.edu.in
midsr.latur@gmail.com

Website : www.mitmidsr.edu.in



GPS Map Camera

Latur, Maharashtra, India
CHJH+36W, Vishwanathpuram, Latur,
Maharashtra 413512, India
Lat 18.429896°
Long 76.577904°
07/03/23 11:45 AM GMT +05:30

LCD PROJECTOR



GPS Map Camera

Latur, Maharashtra, India
CHJH+36W, Vishwanathpuram, Latur,
Maharashtra 413512, India
Lat 18.429897°
Long 76.577906°
07/03/23 11:23 AM GMT +05:30

AUTOCLAVE FOR BULK INSTRUMENT STERILIZATION VACUUM (FRONT LOADING)



MAEER PUNE's

MAHARASHTRA INSTITUTE OF DENTAL SCIENCES & RESEARCH (DENTAL COLLEGE)



Address : Vishwanathpuram Ambajogai Road,
Latur. 413531 (Maharashtra)

Tel : (02382) 227703, 227424
Fax : (02382) 228063

Email : principal@mitmidr.edu.in
midr.latur@gmail.com

Website : www.mitmidr.edu.in



GPS Map Camera



Latur, Maharashtra, India
CHJH+36W, Vishwanathpuram, Latur,
Maharashtra 413512, India
Lat 18.429897°
Long 76.577906°
07/03/23 11:19 AM GMT +05:30

NEEDLE DESTROYER



GPS Map Camera



Latur, Maharashtra, India
CHJH+36W, Vishwanathpuram, Latur,
Maharashtra 413512, India
Lat 18.429898°
Long 76.577907°
07/03/23 11:38 AM GMT +05:30

DRY HEAT STERILIZER



MAEER PUNE's

MAHARASHTRA INSTITUTE OF DENTAL SCIENCES & RESEARCH (DENTAL COLLEGE)



Address : Vishwanathpuram Ambajogai Road,
Latur. 413531 (Maharashtra)

Tel : (02382) 227703, 227424
Fax : (02382) 228063

Email : principal@mitmidsr.edu.in
midsr.latur@gmail.com
Website : www.mitmidsr.edu.in



ULTRASONIC SCALER



SETS OF ORTHODONTIC PLIERS



MAEER PUNE's

MAHARASHTRA INSTITUTE OF DENTAL SCIENCES & RESEARCH (DENTAL COLLEGE)



Address : Vishwanathpuram Ambajogai Road,
Latur. 413531 (Maharashtra)

Tel : (02382) 227703, 227424
Fax : (02382) 228063

Email : principal@mitmidsr.edu.in
midsr.latur@gmail.com
Website : www.mitmidsr.edu.in



ORTHODONTIC IMPRESSION TRAYS

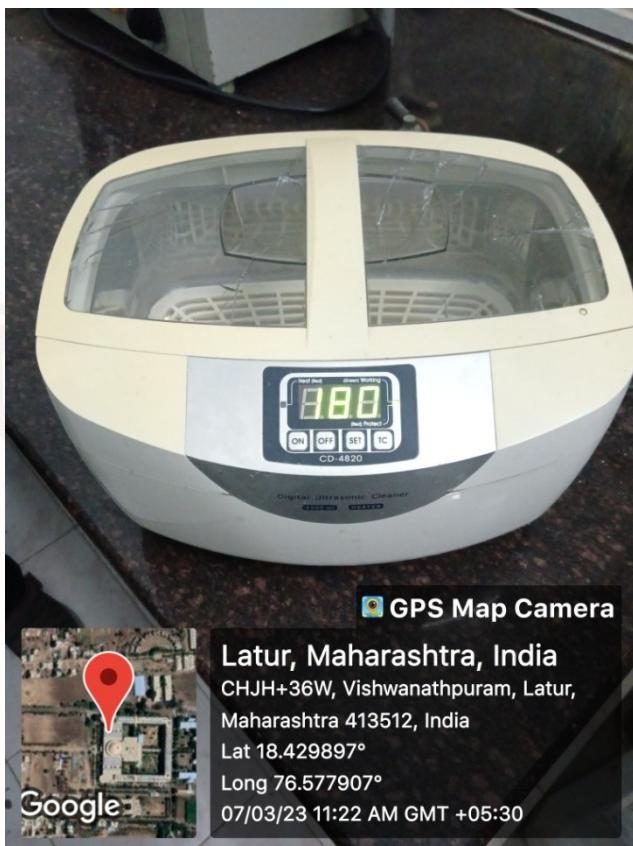

ULTRASONIC CLEANER CAPACITY 3.5 LTS



MAEER PUNE's

MAHARASHTRA INSTITUTE OF DENTAL SCIENCES & RESEARCH (DENTAL COLLEGE)



Address : Vishwanathpuram Ambajogai Road,
Latur. 413531 (Maharashtra)

Tel : (02382) 227703, 227424
Fax : (02382) 228063

Email : principal@mitmidsr.edu.in
midsr.latur@gmail.com
Website : www.mitmidsr.edu.in



ELECTROPOLISHER



TYPODONTS WITH FULL TEETH SET



MAEER PUNE's

MAHARASHTRA INSTITUTE OF DENTAL SCIENCES & RESEARCH (DENTAL COLLEGE)



Address : Vishwanathpuram Ambajogai Road,
Latur. 413531 (Maharashtra)

Tel : (02382) 227703, 227424
Fax : (02382) 228063

Email : principal@mitmidrs.edu.in
midrs.latur@gmail.com
Website : www.mitmidrs.edu.in



GPS Map Camera

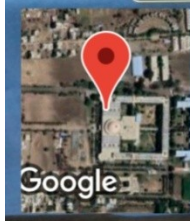

Latur, Maharashtra, India
CHJH+36W, Vishwanathpuram, Latur,
Maharashtra 413512, India
Lat 18.429922°
Long 76.577878°
07/03/23 11:20 AM GMT +05:30

ANATOMICAL ARTICULATOR WITH FACE BOW ATTACHMENTS



GPS Map Camera



Latur, Maharashtra, India
CHJH+36W, Vishwanathpuram, Latur,
Maharashtra 413512, India
Lat 18.429898°
Long 76.577907°
07/03/23 11:36 AM GMT +05:30

FREE PLANE ARTICULATORS



MAEER PUNE's

MAHARASHTRA INSTITUTE OF DENTAL SCIENCES & RESEARCH (DENTAL COLLEGE)



Address : Vishwanathpuram Ambajogai Road,
Latur. 413531 (Maharashtra)

Tel : (02382) 227703, 227424
Fax : (02382) 228063

Email : principal@mitmidr.edu.in
midr.latur@gmail.com
Website : www.mitmidr.edu.in



GPS Map Camera



Latur, Maharashtra, India
CHJH+36W, Vishwanathpuram, Latur,
Maharashtra 413512, India
Lat 18.429897°
Long 76.577907°
07/03/23 11:27 AM GMT +05:30

HINGE ARTICULATORS



GPS Map Camera



Latur, Maharashtra, India
CHJH+36W, Vishwanathpuram, Latur,
Maharashtra 413512, India
Lat 18.429897°
Long 76.577907°
07/03/23 11:40 AM GMT +05:30

COMPUTER SOFTWARE FOR CEPHALOMETRICS



MAEER PUNE'S

MAHARASHTRA INSTITUTE OF DENTAL SCIENCES & RESEARCH (DENTAL COLLEGE)



Address : Vishwanathpuram Ambajogai Road,
Latur. 413531 (Maharashtra)

Tel : (02382) 227703, 227424
Fax : (02382) 228063

Email : principal@mitmidsr.edu.in
midsr.latur@gmail.com

Website : www.mitmidsr.edu.in

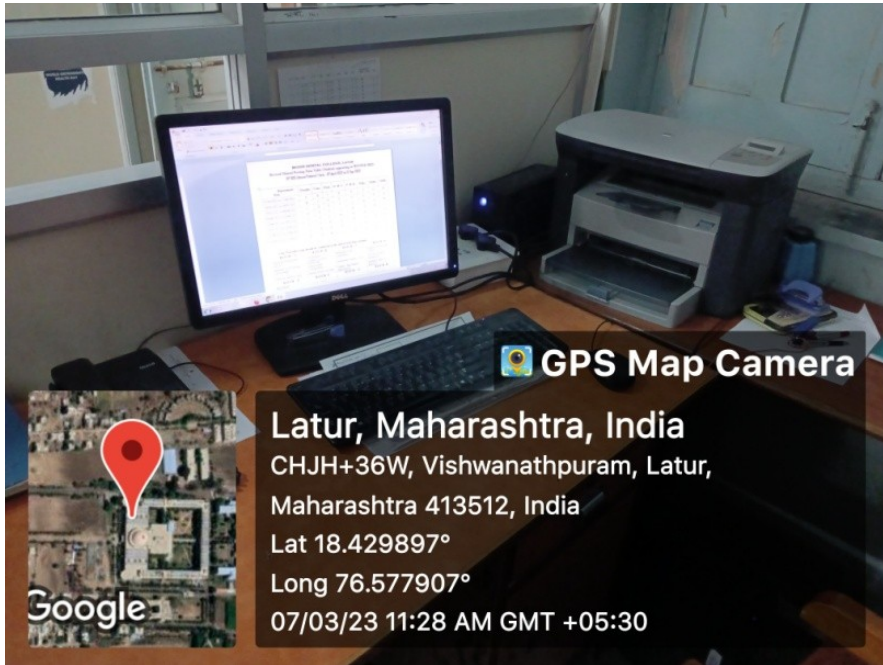

**COMPUTER WITH INTERNET CONNECTION
WITH ATTACHED PRINTER AND SCANNER**



REFRIGERATOR